

Sal-Tech Easy Packaging Packaging Solutions Multihead Weighers, Form, Fill & Seal



WE KEEP THINGS TOGETHER

**Machines,
and
Materials**



sal-tech.com
EASY PACKAGING

Sal-Tech Easy Packaging

Weighing Form, Fill & Seal



Positioning bulk products into defined weight or count and then packaged in vertical formed bag or a horizontal flowpacked tray or the item directly.

MULTIHEAD WEIGHERS

STEP MHW-10-05

Specifications:	
Model	STEP MHW-10-05
Item no.	48291005
Max. Cap.(g)	1-100grams
Weighing Accuracy	±0.1-0.5g
Max Weighing speed	40-60WPM
Hopper Capacity	0,5L
Control system	MCU Control System Optional
Operation Panel	7 inch touch screen
Power Supply	AC220V ±10%, 50Hz/60Hz 1.5KW
Packing Dimension (mm)	1100L)×1100(W)×1780(H)
Net Weight/Packaging Weight	360kg



STEP DIMPLED PLATE OPTION ON MULTIHEAD WEIGHERS

Application:

It is especially suitable for weighing QQ candy, soft candy, jelly, frozen food, meat roll, vegetable, screw, etc. which are sticky, hard-flowing.

Extra Price typically 8-10.000 DKK, but request separeate quote per machine type on ordering.



MULTIHEAD WEIGHERS

STEP MHW-10-16 & STEP MHW-10-25

Specifications:		
Model	STEP MHW-10-16-MCU	STEP MHW-10-25-MCU
Item no.	48291016	48291025
Max. Cap.(g)	10-800g	10-1500g
Weighing Accuracy	±0.1-1.5g	±0.1-2g
Max Weighing speed	70WPM	70WPM
Hopper Capacity	1.6L	2.5L
Control system	MCU Control System Optional at extra cost PLC(Siemens or Rockwell AB)	
Operation Panel	7 inch touch screen	
Power Supply	AC220V ±10%, 50Hz/60Hz 1.5KW	
Packing Dimension (mm)	1100L)×1100(W)×1780(H)	1100L)×1100(W)×1780(H)
Net Weight/Packaging Weight	288KG/400KG	288KG/400KG

Application:

It is suitable for weighing of granule, slice shape such as cereal, pasta, candy, seed, chips, coffee bean, nut, puffy food, biscuit, chocolate, pet food, frozen foods, etc. It is also suitable for non-food industry such as screws, bolts and plastic components.

Main Features:

- Original program can be restored.
- Easy cleaning and maintenance with clean function, all hoppers can stay open
- Piece counting function 4, IP65 certificate 5, Unqualified weight reject 6, Step motor angle can be set according to different product 7, 99 program can be preset

Special Features:

- Modular electronic system makes function expanding and maintenance easier and at lowest cost
- Professional A/D card with high accuracy and stability. Interchange is available
- HMI program with different authority management more user-friendly
- HMI program can be upgraded by U-disk
- PLC control system applied in the weigher and it makes machine more stable and low fault rate. Makes expansion of auto weigh and Packaging System easy.
- Application software can be upgraded by memory card.
- Remote is available
- Application software can be upgraded by memory card.



STEP MHW-14-25 MULTIHEAD WEIGHER

Application:

It is suitable for high speed weighing of granule, slice, roll or irregular shape products such as candy, seed, jelly, fries, coffee bean, peanut, puffy food, biscuit, chocolate, nut, yogurt, pet food & frozen foods, etc. It is also suitable for weighing small metal and plastic parts.



STEP MHW 14-25 HEAD DIMPLED MULTIHEAD WEIGHER

Application:

It is especially suitable for weighing QQ candy, soft candy, jelly, frozen food, meat roll, vegetable, screw etc which are sticky, hard-flowing.

Features:

- Load cell level sensor control material feeding;
- No products Auto pause function can avoid material dropping out during Running;
- The single linear feeder amplitude can be auto/manual adjusted will ensure the products easy-flowing with high accuracy;
- Facility to maximize or minimize the operation angle to the size of the product.
- IP65 waterproof and dustproof design, which is easy to clean and maintain.
- Multilanguage control panel, Spanish, Korean, German, French and Arabic, etc.
- High accuracy and high speed modes can be select.

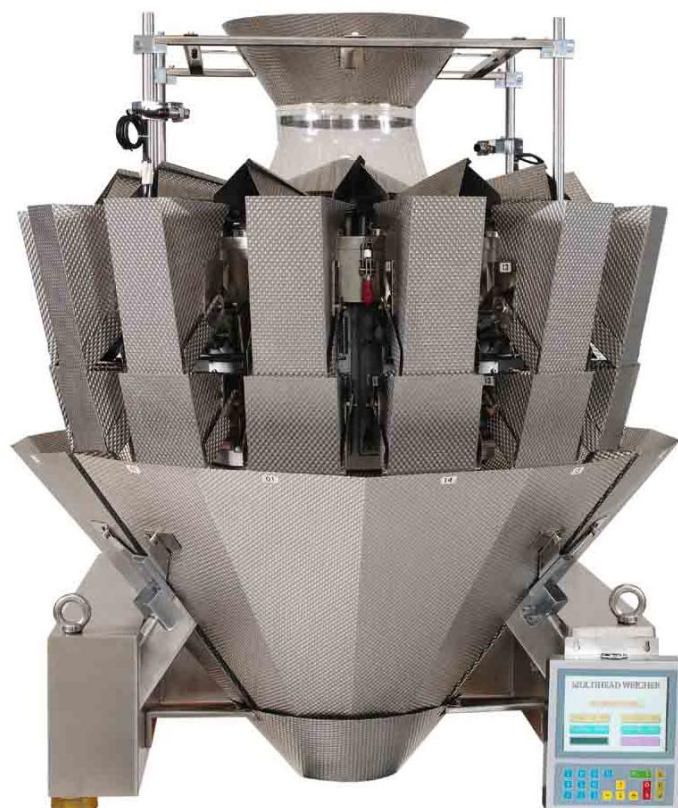

Specifications

Model	STEP MHW-14-25
Item no.	48291425
Max. Cap.(g)	10-3000g
Weighing Accuracy(g)	0.1-1.5g
Max. Weighing Speed	120WPM
Hopper Volume	2500ml
Control Panel	10.4"LCD Keypad Screen/Touch Screen
Options	Dimple Plate/Timing Hopper/Printer/Rotary Top Cone
Driving System	Step Motor
Power Requirements	220V / 1500W / 50/60HZ / 10A
Packing Dimension(mm)	1100(L)x1100(W)x1780(H)
Gross WGT	495KG

STEP MHW-14-50 SALAD MULTIHEAD WEIGHER

Application:

It is suitable for weighing big granule products, beans, nuts, fruits, vegetable and salad with large target weight or volume.

Features:

- High accuracy and high speed modes can be selected;
- Rotary and vibration Top Cone can be selected.
- The single linear feeder amplitude can be auto/manual adjusted will ensure the products easy-flowing with high accuracy;
- IP65 waterproof and dustproof design, which is easy to clean and maintain.
- Multilanguage control panel, Spanish, Korean, German, French and Arabic, etc.



Specifications	
Model	STEP MHW-14-55
Item no.	48291455
Max. Cap.(g)	100-3000g
Weighing Accuracy(g)	1-5g
Max. Weighing Speed	70WPM
Hopper Volume	5500ml
Control Panel	10.4"LCD Keypad Screen/Touch Screen
Options	Dimple Plate/Rotary Top Cone
Driving System	Step Motor
Power Requirements	220V / 2000W / 50/60HZ / 12A
Packing Dimension(mm)	1226(L)x880(W)x1270(H)
Gross WGT	650KG

STEP MHWL-10-50 Multihead Linear 5,0L - 10 Head Linear Potato Weigher

This 10 head weigher is a linear packing machine for potatoes and root crops with speed as quick as 50BPM per 1kg. With an added function of PC technology and connection for an easier control and maintenance.

A VFFS machine that is titled to go beyond linear weighing and packing, this 10 Head Weigher swiftly operate to pack potato crops at a reasonable speed with consistency and precision. Maintaining that produce are of high quality for satisfaction of customers, this also provides a healthier production plant in terms of aiding in efficiency, effectivity, and worker safety.

Features:

- Accuracy and Reliability
- Speed
- Control System
- PC Connection
- USB Function
- Camera
- 10 head as top hopper
- Linear and Multihead Weigher
- Stronger Feeder

Applications:

Potato/orange/carrot/onion/complete farm products

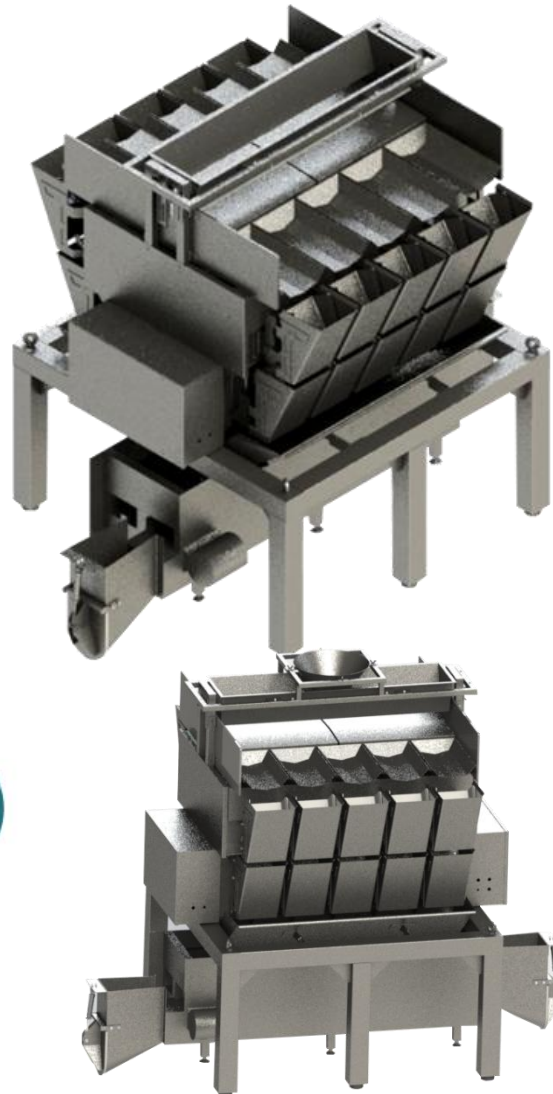

Specifications:	
Model	STEP MHWL-10
Generation	4G
Weighing Range	100g – 5000g
Accuracy	±5g – 20g
Max. Speed	60WPM
Power Supply	380V, 50/60Hz, 2KW
Hopper Volume	5L
Monitor	10.4" in. Color Touch Screen
STEP Item no.	48291050

STEP LW-1-1000 Linear Scale 1 Channel Single-Head Linear Scale Machine

**For Rice, Flour, Tea, Nuts, Food, Almond Dragee
Count and weigh modes – Stainless Steel Construction**

The STEP LSC1-1000 Series Linear Scale Machines have been continuously developed over many years of production to be the most versatile and accurate range of linear weighing currently available. It designed for ease of operation and can be supplied in single units for semi automatic use (hand-presented bags or containers) or in a multiple format to link with automatic packaging machinery.

Simple to operate, the machine is set to a pre-determined pack (target) weight, then the bulk product is loaded into an in feed hopper. Using a vibration mechanism, the product enters the weigh pan, where the system monitors the weight. Once 80% of the target weight has been loaded, the system switches to a dribble feed for the final 20%, thus ensuring optimum accuracy. When the weigher has “made weight”, the product is discharged through specially made outlet chutes designed to suit your specific packaging arrangements. Various configurations are available, covering a weigh range from as little as 50g to as much as 5kg at speeds of up to 30 weighings per minute.(depending on density and flow characteristics) and for synchronization with packaging and existing indexing systems to provided a high speed, fully weight controlled system.

Options

- IP65 protected loadcells and controls
- Statistical information
- Multi discharge
- Count and weigh modes
- Compact design
- Stainless or mild steel construction



Application:

Ideally suited for granules, dry pieces products: Such as rice, Dried Foods, Tea & Coffee, Pet Foods, Nuts & Pulses, Seeds and some heavy density powder like Detergent etc.

Specifications	
Capacity	50-1000g (Classify depending on weigh pan sizes)
Speed	6-8(times/min)
Weighing accuracy	±0.2%
Voltage	220V/50Hz, 1ph or Per customer specification
Power	0.3KW
Machine size	L510×W800×H1100mm
Weight	160kg
Item no.:	48290110

STEP LW-4-3000 LINEAR WEIGHER

Application:

It's suitable for weighing slice, roll or regular shape products such as sugar, salt, seed, rice, sesame, glutamate, milk powder, coffee and seasoning powder, etc.

Special Features:

- Make mix different products weighing at one discharge;
- Adopt no-grade vibrating feeding system to make products flowing more fluently;
- Program can be freely adjusted according to production condition;
- Can be remote-controlled and maintained through internet

General Features:

- Adopt high precision digital load cell;
- Stable PLC system control;
- Color touch screen with Multilanguage control panel;
- Sanitation with 304# S/S construction;
- The parts contacted products can be easily mounted without tools;
- IP65 grade construction.



Specifications:	Models		
	STEP LW-4-3000	STEP LW-4-500	STEP LW-4-5000
Weighing Range	20~2000g	5~200g	100~3000g
Accuracy	0.2-2g	0.1-1g	0.5-3g
Weighing Speed	10~60wpm	30~70wpm	10~30wpm
Hopper Volume	3000mL	500mL	5000mL
Preset Programs	20	20	20
Max. Mix-Products	4	4	2
Power	800W	800W	1000W
Power Supply	220V/ 50/60HZ/8A	220V/50/60HZ/8A	220V/50/60HZ/10A
Item no.	48330430	48330430-500	48330430-5000

STEP CW-E2 CHECK WEIGHER

Application:

It is used to check whether the single bag weight is conformed to the preset weight or not, and auto remove off the unqualified products by the selecting device.

Features:

- Adopt advanced digital load cell to obtain high-speed and stable weighing;
- User-friendly touch screen with English languages;
- It can record each operation due to the strong data statistic function;
- It is convenient to maintain due to unloading belt;
- Frame with IP65 protection and 10 preset product data models.



Items/Specifications	Standard Weight Range			
	10-99g	100-500g	501-600g	601-999g
Speed(Bags/Minute)	65	60	50	50
Accuracy(g)	±0.5g	±0.5g	±0.8g	±1g
Min. Scale(g)	0.1	0.1	0.1	0.1
Product Preset Programs	10	10	10	10
Dimension(mm)/Weight	1380(L)X560(W)X1200(H)/150KG			
Reject System	Pneumatic/Pusher/Diverter/Drop/Select			
Voltage/Frequency/Power	AC220V ±10%/50Hz/500W			
Belt Height /size	700mm/350x180mm(depend on requirements)			
Item no.:	48401010-100	48401010-500	48401010-600	48401010-1000

STEP JW-B1 VERTICAL WEIGHING PACKAGING SYSTEM

The Units:

- Large vertical automatic packaging machine.
- Multihead weigher
- Working platform
- Z type conveyer
- Vibrating feeder
- Finished products conveyer

Features

- Fully-automatically complete all the process from feeding, weighing, filling and bag-making, date-printing to finished products outputting.
- High weighing precision and efficiency.

Range of Application:

It is suitable for weighing of granule, slice, roll or irregular shape products such as candy, seed, jelly, fries, coffee, granule, peanut, puffyfood, biscuit, chocolate, nuts, pet food, frozen foods, etc. It is also suitable for weighing small hardware and plastic component.



Specifications

System Output	≥3500 tons per year.
Packaging Speed	30-70 ppm.
Packaging Accuracy	±0.2-1.5g (depends on the material)
Packaging Capacity	10~1500g
Operation Panel	English, Spanish and Korean etc.

STEP JW-B3 MANUAL PACKAGING SYSTEM

The Units:

- Diverter device
- Multihead weigher
- Z type conveyer
- Vibrating feeder
- Working platform
- Collection bucket

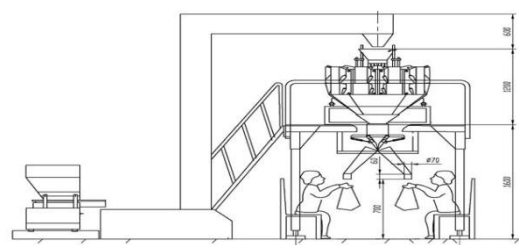

Features

- Automatically complete all the process from feeding, weighing, filling and bag making, date printing to finished products outputting.
- Discharge and seal by hand.
- High Weighing precision and efficiency without crashing and wasting material.

Range of Application:

It's suitable for packing kinds of products with good-made bags, such as: puffy food, potato chips, popcorn, jelly, candy, happy fruit, apple chip, boiled dumpling, rice dumpling and medicine, etc.

Specifications

System Output	≥3300 tons per year.
Packaging Speed	30-70 ppm.
Packaging Accuracy	±0.3 - 1.5g
Packaging Capacity	10~3000g
Operation Language	English

STEP JW-B4 ONE PLUS TWO SYSTEMS

The Units:

- Vibrating feeder
- Z type conveyor
- 14 head multihead weigher
- Working platform
- Diverter device
- Double-tuber packaging machine
- Finished products conveyor

Features

- It is suitable for weighing and packaging grain, slice, roll or irregular shape materials;
- It can fully automatically finish the whole procedure from material feeding, weighing, diverting, packaging to finished-products conveyor;
- This system is compact and rigid, which will save your labor cost and enhance your productivity.
- It will save your room and improve your production management.

Specifications:

System Output	6430 Ton/Year
Packaging Speed	30-70 Bags/Min
Packaging Accuracy	±0.3~1.5g



STEP JW-B5 4-HEAD LINEAR WEIGHER SYSTEM

The Units:

- Bucket Elevator
- 4 Head Linear Weigher
- Vertical Bagging Machine
- Finished products conveyor

Features

- It is suitable for weighing and packaging grain, slice, roll or irregular shape materials;
- It can fully automatically finish the whole procedure from material feeding, weighing, diverting, packaging to finished-products conveyor;
- This system is compact and economical, which will save your labor cost and enhance your productivity.

Specifications

System Output	3220 Ton/Year
Packaging Speed	30-50 Bags/Min
Packaging Accuracy	±0.3~2g



WEIGHERS ADD-ONS

STEP MG Series Mini Table Top Auto Feed Scale

This Mini Scale Table Top provides semi-automatic weighing with a simple configuration level. It is most suitable for light duty jobs like shops selling coffee powder, beans, tea nuts, powder, grains, seeds etc. Both versions are suited for packing granules, grains and other agricultural crops related products.

Vibration Channel for Feeding – Suitable for packaging powdered products such as Sugar, Powdered milk, refined salt and others.

Vibration Bowl for Feeding – Suitable for granules such as Coffee beans, beans, grains, seeds and others.



Specifications						
Version	Vibration Channel for Feeding	Vibration Bowl for Feeding	Vibration Channel for Feeding	Vibration Bowl for Feeding	Vibration Channel for Feeding	Vibration Bowl for Feeding
Item Name	STEP MG-50 VC	STEP MG-50 VB	STEP MG-100 VC	STEP MG-100 VB	STEP MG-200 VC	STEP MG-200 VB
Filling Capacity	1-50g	1-50g	1-100g	1-100g	5-200g	5-200g
Accuracy	0.1-0.2g, depends on material	0.1-0.2g, depends on material	0.1-0.2g, depends on material	0.1-0.2g, depends on material	0.1-0.2g, depends on material	0.1-0.2g, depends on material
Speed	10-25 times/min, speed adjustable;	10-25 times/min, speed adjustable;	10-20 times/min, speed adjustable	10-20 times/min, speed adjustable	10-20 times/min, speed adjustable	10-20 times/min, speed adjustable
Fabric	SS201 Cover, SS304 Contact	SS201 Cover, SS304 Contact	SS201 Cover, SS304 Contact	SS201 Cover, SS304 Contact	SS201 Cover, SS304 Contact	SS201 Cover, SS304 Contact
Machine Dimension	380mm x 230mm x 500mm	380mm x 230mm x 500mm	380mm x 230mm x 550mm	380mm x 230mm x 550mm	450mm x 300mm x 680mm	450mm x 300mm x 680mm
Net Weight	Net: 10 KG;	Net: 10 KG;	12 Kg	12 Kg	18 Kg	18 Kg
Power	110/220V. 50/60Hz, 180W;	110/220V. 50/60Hz, 180W;	110/220V. 50/60Hz, 180W	110/220V. 50/60Hz, 180W	110/220V. 50/60Hz, 220W	110/220V. 50/60Hz, 220W
Electric	MCU, Digital Meter, Taiwan Load Cells	MCU, Digital Meter, Taiwan Load Cells	MCU, Digital Meter, Taiwan Load Cells	MCU, Digital Meter, Taiwan Load Cells	MCU, Digital Meter, Taiwan Load Cells	MCU, Digital Meter, Taiwan Load Cells
STEP Item No.	48251050	48251055	48251100	48251105	48251200	48251205

Sal-Tech Easy Packaging Packaging Solutions

VFFS - Multiple Series
Vertical Form, Fill & Seal



WE KEEP THINGS TOGETHER

**Machines,
and
Materials**

STEP VFFS

Vertical Form Fill & Seal machines – V Series

420mm Film Width Machines



STEP VFFS V420.2

Double Servo Vertical Bagging machine

Stainless steel machine frame, controlled by PLC and HMI

Max film width:	420mm
Packing speed:	5-100 bags per min
Bag width:	60-200mm
Bag length:	50-230mm

Item no:	48381010
----------	----------

STEP VFFS V420.1 + MHW10

Single Servo Vertical Bagging machine + Multihead Weigher 10head 1L

Stainless steel machine frame controlled by PLC and HMI

Max film width:	420mm
Packing speed:	25-60 bags per min
Bag width:	60-200mm
Bag length:	50-230mm

Item no:	48381210
----------	----------

STEP VFFS V420.2 + MHW14

Double Servo Vertical Bagging machine + Multihead Weigher 14head 1L

Stainless steel machine frame controlled by PLC and HMI

Max film width:	420mm
Packing speed:	25-100 bags per min
Bag width:	60-200mm
Bag length:	50-230mm

Item no:	48381220
----------	----------



GREAT COMBO DEAL

520mm Film Width Machines

STEP VFFS V520.1

Single Servo Vertical Bagging machine

Stainless steel machine frame

controlled by PLC and HMI

Max film width 520mm

Packing speed:5-60 bags per min

Bag width 60-250mm

Bag length 50-300mm

Item no: 48381020

STEP VFFS V520.2

Double Servo Vertical Bagging machine

Stainless steel machine frame

controlled by PLC and HMI

Max film width 520mm

Packing speed:5-100 bags per min

Bag width 80-250mm

Bag length 50-300mm

Item no: 48381030



620mm Film Width Machines

STEP VFFS V620.1

Single Servo Vertical Bagging machine

Stainless steel machine frame

controlled by PLC and HMI

Max film width 620mm

Packing speed:5-60 bags per min

Bag width 110-300mm

Bag length 50-380mm

Item no: 48381040

STEP VFFS V620.2

Double Servo Vertical Bagging machine

Stainless steel machine frame

controlled by PLC and HMI

Max film width 620mm

Packing speed:5-100 bags per min

Bag width 110-300mm

Bag length 50-380mm

Item no: 48381050



800mm Film Width Machines



STEP VFFS V800.1

Single Servo Vertical Bagging machine

Stainless steel machine frame
controlled by PLC and HMI
Max film width 800mm
Packing speed: 5-40 bags per min
Bag width 160-385mm
Bag length 50-480mm

Item no: 48381060

STEP VFFS V800.2

Double Servo Vertical Bagging machine

Stainless steel machine frame
controlled by PLC and HMI
Max film width 800mm
Packing speed: 5-80 bags per min
Bag width 160-385mm
Bag length 50-480mm

Item no: 48381070

Options STEP VFFS Series

48611060-1	Additional bag former
48611060-2	Bag support
48611060-3	Nitrogen flushing device
48611060-4	Sponge inflator

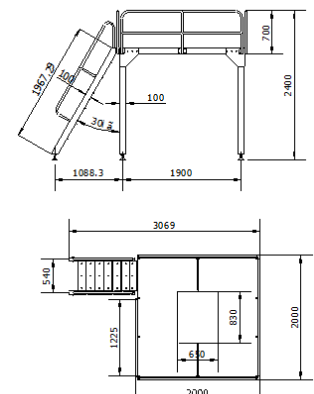

Support Equipment for VFFS lines

STEP WP

Platform to support Multihead weigher

No rail no ladder
1400x1200x1400mm

Item no: 48619010

Platform WP1.8

Stainless steel #304 Frame
Size 2000x2000x1800 for 520series VFFS

Item no: 48619020

Platform WP2.25

Stainless steel #304 Frame
Size 2000x2000x2250 for 800series VFFS

Item no: 48619040



STEP Z-Shaped Conveyor

Z-shaped conveyor with vibration hopper

Stainless steel #304 Frame and Stainless steel Vibration Hopper and 1.8 L Food Grade PP bucket

Elevated height: **3.2**meter

Electrical connection: 380V 50Hz

Item no: 48618010-3218

Z-shaped conveyor with vibration hopper

Stainless steel #304 Frame and Stainless steel Vibration Hopper and 1.8 L Food Grade PP bucket

Elevated height: **3.8**meter

Electrical connection: 380V 50Hz

Item no: 48618010-3818

General item numbers:

- 48618010-HHLL with vibrator
- 48618020-HHLL without vibrator

And HHLL is height in 100mm and LL is liters per bucket



Main Features:

- The conveyer is applicable for vertical lifting of granule material such as corn, food plastic and chemical industry, etc.
- Convey speed: 5.5m³/h
- Convey height: 3.3~3.6m
- Be made of 304#stainless steel or painted steel
- Item no. 48618050-HHHH

STEP L-Shaped Conveyor

L-shaped conveyor

Stainless steel #304 Frame

Food gade belt 300mm wide

Elevated height: **3.2**meter

Electrical connection: 380V 50Hz

Item no: 48618050

L-shaped conveyor

Stainless steel #304 Frame

Food gade belt 300mm wide

Elevated height: **3.8**meter

Electrical connection: 380V 50Hz

Item no: 48618060

STEP Finished Products Conveyor**STEP Output Conveyor****Output conveyor**

Stainless steel #304 Frame

Food grade belt 200mm wide

Item no: 48618070

Main Features:

- The machine is for transporting the finished products to the check machines and packaging platform.
- Height: 1.2~1.5m.
- Convey volumes: 1m³/h.
- Item no. 48501030

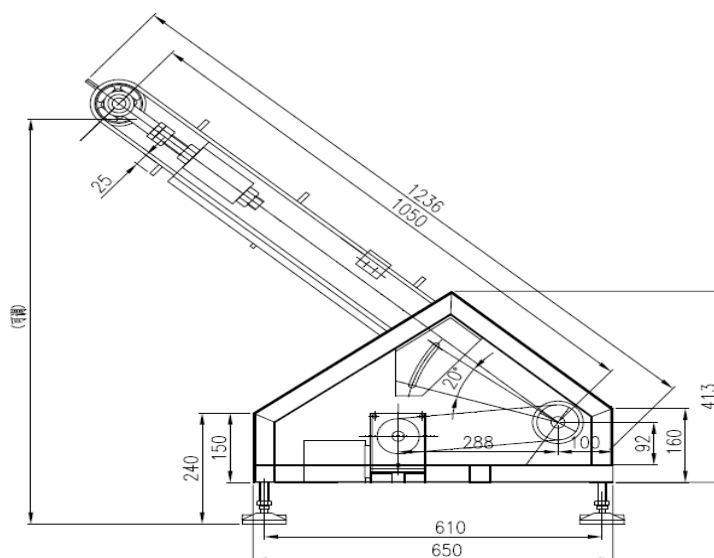
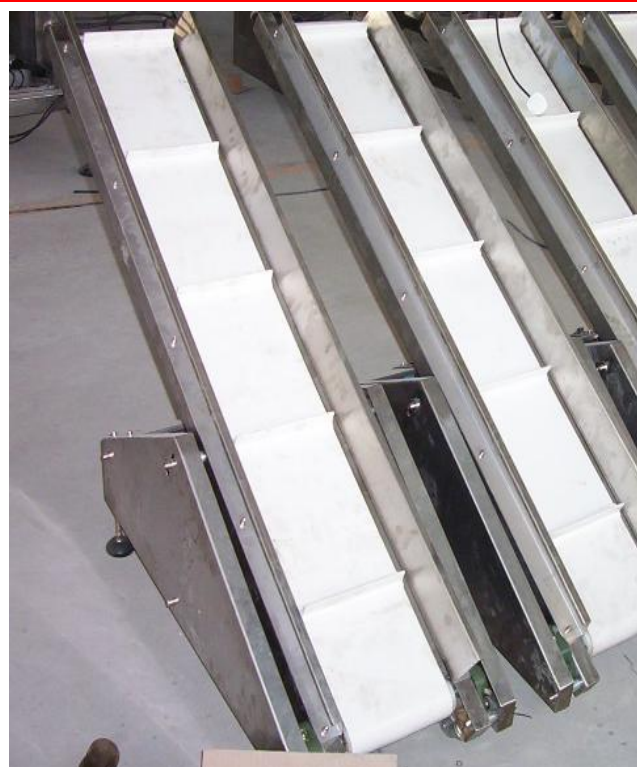
**Structure Chart:**

Specifications	Model		
	JW-D1	JW-D2	JW-D3
Conveying Height	3300~3600mm	1600~2400mm	1200~1500mm
Conveying Volume	5.5m ³ /h		1m ³ /h
Packing Size(mm)	2000Lx1100Wx500H	2100Lx2050Wx500H	1600Lx500Wx1100H
STEP Item no.			

STEP Link Plate Output Conveyor

Link Plate Output conveyor

Stainless steel #304 Frame

Food grade belt 200mm wide

Item no: 48618080



STEP Vertical Form, Fill and Seal Packaging Machines

Equipment for outfitting the food packaging area



Product tray and lift



Round outlet collection table

48501040



Infeed vibrator



Feeder

Bag types for VFFS:

All the machine we support can do pillow bag as standard and then some can do other configuration upon request.



Vibrator Feeders

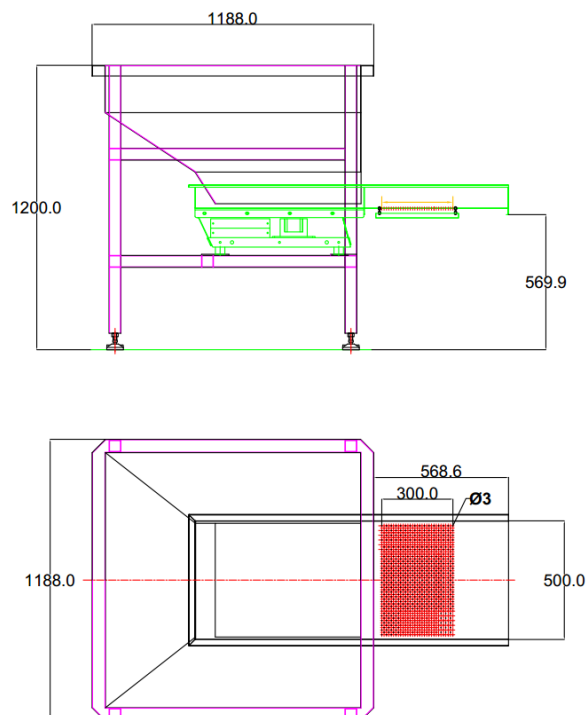

Vibrator feeders secure a smooth on let of product to conveyors giving a better overall flow and control of batch weight and can be used for dust removal.

Specifications	Model		
	STEP VF 130	STEP VFDR-300	STEP VFDR-500
Outlet width	150mm	300mm	500mm
Mesh for dust removal size	None	300x296 – ø3	300x496 ø3
Hopper size	130 liter	375 liter	375 liter
Volume per hour *1	0 to 4.0 m3/h	0.8,0 m3/h	0 to 15 m3/h
Packing Size(mm)			
STEP Item no.	48610040	48618090	48618100

Note *1.: Dependent of product desity and composition.

Item 48618090 and 48618100 made and added to catalog 3367 and QT 123351 made for customer. STG layout have been made. All in INF. 070821 GUS

STEP Vibrator 400mm with 2 outlet light products w. Dust mesh



Side View



Back View

The product vibrates and feeds onto additional equipment like the Bucket Elevator and Acclivitous Conveyor. SUS304 is used for all contact components, which is sanitary and food-safe. With the aid of a control circuit and level sensors, it can start and stop feeding automatically.

SPECIFICATIONS	
Model	STEP Vibrator 400mm x2 outlet light products w. Dust mesh
Item Number	48618120
Power	220-240V, 50Hz, 0.5KW
Conveying ability	Over 20 m3/h product dependent
Overall dimensions (L*W*H)	1535*1188*1200mm
Net Weight	180kg
Gross Weight	280kg

Features

- Easy Automatic Feed Control.
- A wide variety of handling materials are available.
- Low-cost operation.
- Appropriate for specialist use.

Safety Measures

1. Designed for long-term use.
2. Very Low maintenance.
3. CE Certification.

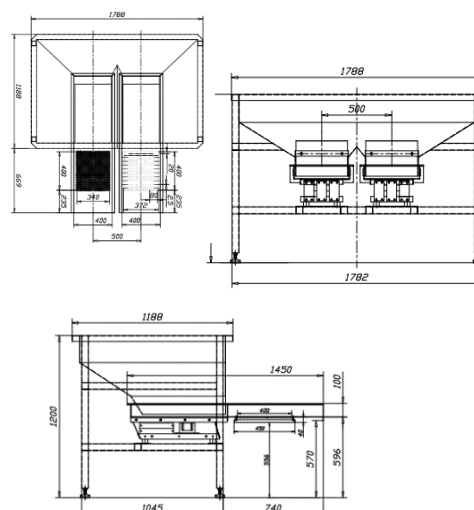

STEP VFFS

Vertical Form Fill & Seal machines – STEP SGB Series



Irregular Products



Powder Products



Regular Products



Technical Index:

Model:	SGB480	SGB630	SGB780	SGB1080
Length Range:	100-300mm	100-450mm	200-450mm	400-900mm
Width Range:	100-210mm	100-300mm	120-380mm	300-520mm
Film Width:	200-480mm	200-630mm	240-780mm	640-1080mm
Speed:	25-55BPM	25-55BPM	25-40BPM	5-25BPM
Power Supply:	220v-380V / 50HZ / 60HZ 1/3 Phase 5-10KW (Customized)			

STEP VFFS

Vertical Form Fill & Seal machines – STEP SGB Series

180-630mm Film Width Machines

STEP VFFS SGB630/S Automatic Vertical Packing Machine

Basic Machine Description

- STEP VFFS SGB630 Automatic Vertical Packing Machine Unit is specially designed for roll film fully automatic vertical bag forming.
- Now this machine has two models which we name SGB780 and SGB780S; the first machine model is for laminated film bag forming and the second one is for PE film bag forming
- The whole machine frame shall use SS304 Stainless Steel Structure to meet the food packing requirements.
- The machine unit shall adopt Siemens PLC controlling system with easy operating Touch Screen.



Basic Machine Unit Parameters

Machine Model:	STEP VFFS SGB630 / SGB630S
Packing Material:	Potatoes / Root Crops / Vegetables
Packing Weight:	1kg – 3kg (Depend on Material)
Bag Size Range:	W: 80-275mm L:50-460mm
Film Width:	180-630mm
Packing Speed:	About 10-45 BPM (Depend on Material)
Voltage Supply:	380v / 50HZ 3Phase Customized
Power Supply:	About 6kw
Machine Size	1825 X 1450 X 2100 mm
STEP Item no.:	48621040/48621050

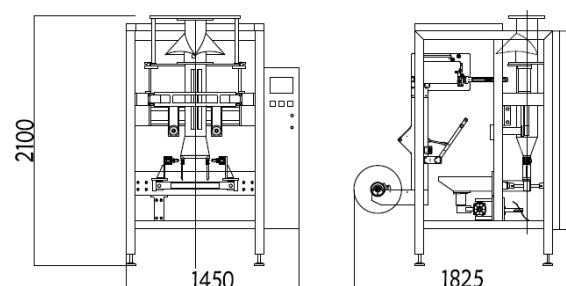

Detailed Picture Showing



Main Electrical Parts Showing

STEP VFFS SGB630 Machine Model for Laminated Film

Touch Screen:	Germany Siemens
PLC:	Germany Siemens
Temperature Controller:	Xiamen Yu Dian
Servo Motor & Servo Drive:	France Schneider
Middle Relay:	Chint
Solid State Relay:	Chint
Phase Sequence Protector:	Chint
AC Contactor:	Chint
Motor Circuit Breaker:	Chint
Air Switch:	Chint

STEP VFFS SGB630S Machine Model for Single PE Film

Touch Screen:	Germany Siemens
PLC:	Germany Siemens
Temperature Controller:	Germany Ropex
Servo Motor & Servo Drive:	France Schneider
Middle Relay:	Chint
Solid State Relay:	Chint
Phase Sequence Protector:	Chint
AC Contactor:	Chint
Motor Circuit Breaker:	Chint
Air Switch:	Chint

STEP VFFS SGB780/S Automatic Vertical Packing Machine

260-780mm Film Width Machines

Basic Machine Description

- STEP VFFS SGB780 Automatic Vertical Packing Machine Unit is specially designed for roll film fully automatic vertical bag forming.
- Now this machine has two models which we name SGB780 and SGB780S; the first machine model is for laminated film bag forming and the second one is for PE film bag forming
- The whole machine frame shall use SS304 Stainless Steel Structure to meet the food packing requirements.
- The machine unit shall adopt Siemens PLC controlling system with easy operating Touch Screen.



Basic Machine Unit Parameters

Machine Model:	STEP VFFS SGB780 / SGB780S
Packing Material:	Potatoes / Root Crops / Vegetables
Packing Weight:	1kg – 5kg (Depend on Material)
Bag Size Range:	W: 120-380mm L:200-450mm
Film Width:	260-780mm
Packing Speed:	About 25 BPM (Depend on Material)
Voltage Supply:	380v / 50HZ 3Phase Customized
Power Supply:	About 6kw
Machine Size	1825 X 1450 X 2100 mm
STEP Item no.:	48621060/48621070

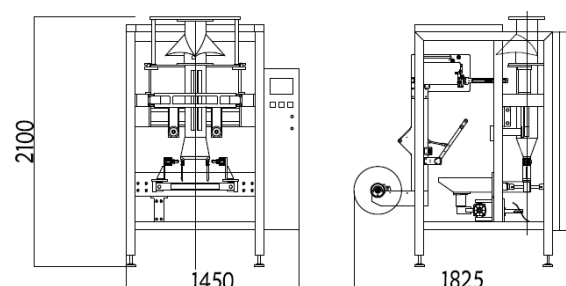

Detailed Picture Showing



Main Electrical Parts Showing

STEP VFFS SGB780 Machine Model for Laminated Film

Touch Screen:	Germany Siemens
PLC:	Germany Siemens
Temperature Controller:	Xiamen Yu Dian
Servo Motor & Servo Drive:	France Schneider
Middle Relay:	Chint
Solid State Relay:	Chint
Phase Sequence Protector:	Chint
AC Contactor:	Chint
Motor Circuit Breaker:	Chint
Air Switch:	Chint

STEP VFFS SGB780S Machine Model for Single PE Film

Touch Screen:	Germany Siemens
PLC:	Germany Siemens
Temperature Controller:	Germany Ropex
Servo Motor & Servo Drive:	France Schneider
Middle Relay:	Chint
Solid State Relay:	Chint
Phase Sequence Protector:	Chint
AC Contactor:	Chint
Motor Circuit Breaker:	Chint
Air Switch:	Chint

STEP VFFS SGB1080/S Automatic Vertical Packing Machine

620-1080mm Film Width Machines

Basic Machine Description

- STEP VFFS SGB1080 Automatic Vertical Packing Machine Unit is specially designed for roll film fully automatic vertical bag forming.
- Now this machine has two models which we name STEP VFFS SGB1080 and STEP VFFS SGB1080S; the first machine model is for laminated film bag forming and the second one is for PE film bag forming
- The whole machine frame shall use SS304 Stainless Steel Structure to meet the food packing requirements.
- The machine unit shall adopt Siemens PLC controlling system with easy operating Touch Screen.

Basic Machine Unit Parameters

Machine Model:	STEP VFFS SGB1080 / SGB1080S
Packing Material:	Potatoes / Root Crops / Vegetables
Packing Weight:	3kg – 10kg (Depend on Material)
Bag Size Range:	W: 300-520mm L:400-900mm
Film Width:	620-1080mm
Packing Speed:	About 15-20 BPM (Depend on Material)
Voltage Supply:	380v / 50HZ 3Phase Customized
Power Supply:	About 7kw
Machine Size	2200 X 1650 X 2580 mm
STEP Item no.:	48621080/48621090



STEP VFFS SGB 1080 Machine Model for Laminated Film

Touch Screen:	Germany Siemens
PLC:	Germany Siemens
Temperature Controller:	Xiamen Yu Dian
Servo Motor & Servo Drive:	France Schneider
Middle Relay:	Chint
Solid State Relay:	Chint
Phase Sequence Protector:	Chint
AC Contactor:	Chint
Motor Circuit Breaker:	Chint
Air Switch:	Chint

STEP VFFS SGB1080S Machine Model for Single PE Film

Touch Screen:	Germany Siemens
PLC:	Germany Siemens
Temperature Controller:	Germany Ropex
Servo Motor & Servo Drive:	France Schneider
Middle Relay:	Chint
Solid State Relay:	Chint
Phase Sequence Protector:	Chint
AC Contactor:	Chint
Motor Circuit Breaker:	Chint

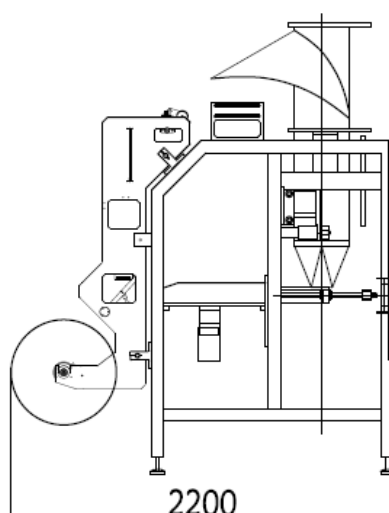
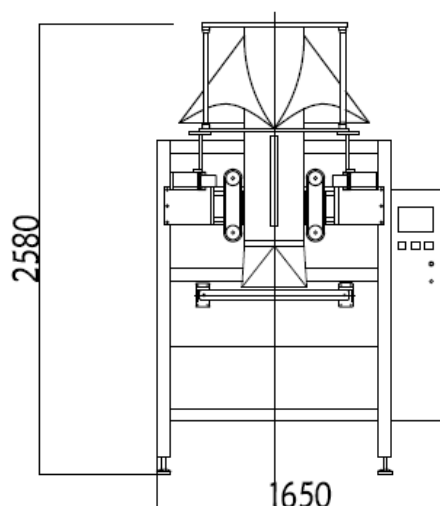

STEP VFFS

Vertical Form Fill & Seal machines

STEP VFFS PM Series

600mm Film Width Machines

1.1 STEP VFFS PM620 New generation vertical packaging machine for pillow bag style (Stainless steel frame)

Product:	Crops (like potatoes, root crops)
Filling range:	500-3000ml
Bag shape:	Pillow bag
Request bag size:	(W) X (L) mm (to be confirmed)
Packing speed:	15-45 bags/min (according to product)
Film Width:	600mm (one former included)

Bag size Range:	W ≤285mm x L ≤500mm
Back sealing width:	15mm
Horizontal sealing:	straight line, Space 3mm ,width: 15mm
Film pulling system:	By servo motor with double belts
Horizontal sealing way:	By pneumatic
Cutting way:	Serrate knife cutting(space 3mm)
Packaging Material:	laminated film, like: BOPP/PE
Power:	220V/50HZ Single phase,4KW
Air pressure:	6Kg Consumption:2m3/min

STEP Item no. : 48631040



800mm Film Width Machines

1.1 STEP VFFS PM800 New generation vertical packaging machine for pillow bag style (Stainless steel frame)

Same as STEP VFFS PM600 except:

Filling range:	1000-5000ml
Packing speed:	10-40 bags/min (according to product)
Max Film Width:	800mm (one former included)
Bag size Range:	150mm ≤ W ≤ 350mm x L ≤600mm

STEP Item no. : 48631060

Basic Feature:

- 7 inch Inovance color touch screen + Omron PLC, with error prompt and self-diagnose functions.
- Servo motor control on film pulling and sealing system, with double belts film pulling device.
- Schneider or Omron electronic elements.
- Material of contacting product surface is SUS 304
- "AIRTAC" Pneumatic component, Omron PID temperature control.

OPTIONS:

1.2 DH-7R Ribbon date coder (ribbon width: 25mm)

Ribbon width: 25mm Printer line:2 lines Each line max capacity is 10 characters character size: 3(H)*2(W) mm

1.3 Extra former

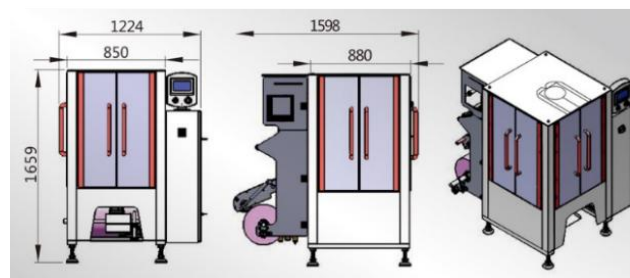

STEP VFFS

Vertical Form Fill & Seal machines

STEP VFFS ATV Series

160-620mm Film Width Machines

No.	Description
1	Form Fill Seal Machine STEP VFFS ATV300 *Stainless Steel structure; *Max. film width 620mm, bag width 70-300mm, bag length 100-300mm. *Eye market sensor & date printer included. *One set spare parts included *Servo-driven for film pulling ONLY; *Standard machine is only for laminated film and pillow bag. STEP item no.: 48641040
Optional items	
a.	Additional bag former
b.	Safety device
c.	Impulse PE sealing system (with water chiller)
d.	Material stopper(for pillow bag and laminated film only)
e.	Bag support (for packing more than 1kg)



320-800mm Film Width Machines

2	Form Fill Seal Machine STEP VFFS ATV800 *Stainless Steel structure *Max film width 800mm, bag width 150-385mm, bag length 100-400mm. *Eye market sensor & date printer included. *One set spare parts included *Servo-driven for film pulling ONLY; *Standard machine is only for laminated film and pillow bag. STEP Item no.: 48641060
Optional items	
a.	Additional bag former
b.	Safety device
c.	Impulse PE sealing system (with water chiller)
d.	Material stopper(for pillow bag and laminated film only)
e.	Bag support (for packing more than 1kg)



STEP DH3F Series Double Hoppers Weighing & Filling Machine Unit

is specially designed for packing granular materials like granular fertilizers, chemical industries, seeds, peanuts, nutlet, rock candy, pine nut, sunflower seeds.



Features:

- Adopting multistage trip and vibration feeding device to ensure better weighing range with good accuracy for max. and min. weight.
- Uses PLC control for the hanging weighing system and meet the requirements of IP54 dustproof and waterproof standard.
- Consists of semi-automatic weighing machine, conveyor and bag sewing machine or heat-sealing machine and other equipment can be equipped according to customer's actual needs.

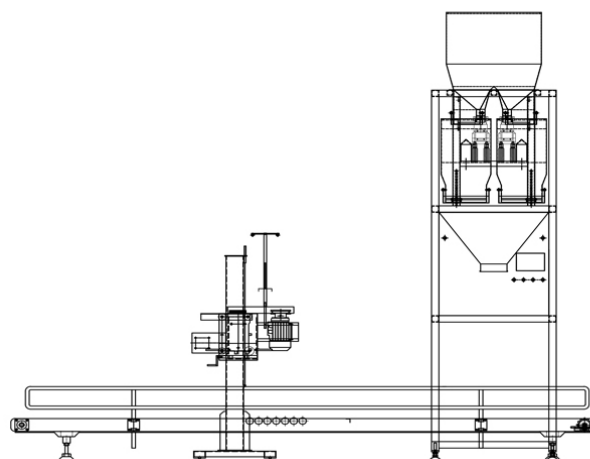
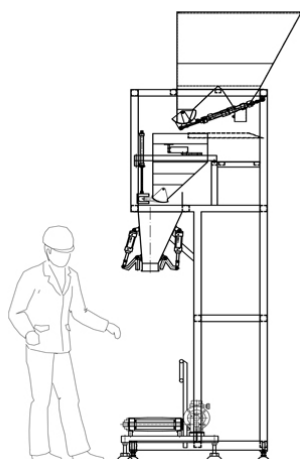

Specifications

Model	STEP DH3F-2-060	STEP DH3F-2-460	STEP DH3F-2-920
Weighing Range / Hopper	50g – 5Kg	1-25 Kg	20-50 Kg
Drive Type	PMSM	Pneumatic & Electric	Pneumatic
Weighing Accuracy	$\leq \pm 0.2 \%$ (according to material characteristics)	$\leq \pm 0.2 \%$ (according to material characteristics)	$\leq \pm 0.2 \%$ (according to material characteristics)
Weighing Speed	12-20 bpm	10-20 bpm	10-15 bpm
Bucket Capacity	6L	46L	92L
Power / Current	1 KW / 6A	5 KW / 13A	6 KW / 16A
Voltage	AC 380V 50/60 Hz (Customized)	AC 380V 50/60 Hz (Customized)	AC 380V 50/60 Hz (Customized)
STEP Item No.	48261050	48262460	48262920

STEP JW-AX1 Single Hopper Bulk Weighing and filling unit



is specially designed for packing granular materials like granular fertilizers, chemical industries, seeds, peanuts, nutlet, rock candy, pine nut, sunflower seeds.

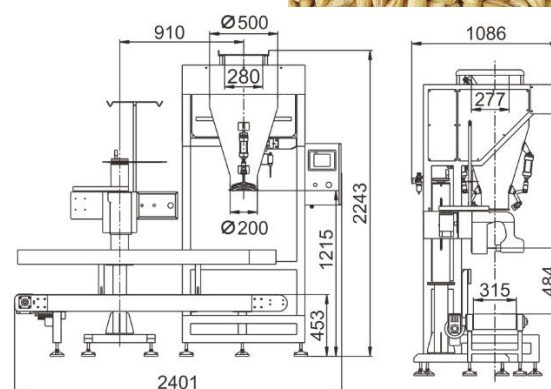
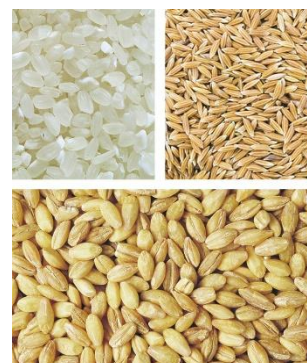

Shown with options:

- Conveyer belt
- Sewing machine for bag closing



Specifications	
Model	STEP JW-AX1
Weighing Range / Hopper	50g – 5Kg
Control Panel	7" Touch Screen
Weighing Accuracy	$\leq \pm 0.2 \%$ (according to material characteristics)
Weighing Speed	7-11 bpm
Bucket Capacity	6L
Power / Current	80W / 0,4A
Voltage	AC 230V 50Hz (Customized)
STEP Item No.	48300145

STEP Small bag/pouch filler machines

STEP DCK-200/240/300 Automatic Three-Side Sealing Granulat Packaging Machine

GRANULAT

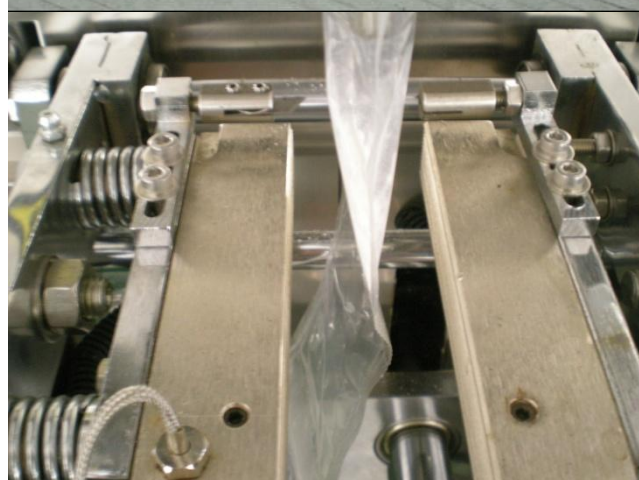

Many option and add ons can be applied.

Model	STEP DCK-200Three-side/Four-side Sealing	STEP DCK-240Three-side/Four-side Sealing	STEP DCK-300Three-side/Four-side Sealing
Method of Measurement	Cup Type		
Range of Measurement	5-100ml 0-5ml (fixed cup on single tray)	5-100ml (Six cups on double trays) 0-5ml (fixed cup on single tray)	5-330ml 5-80ml (Six cups on double trays) 50-330ml (Four cups on double trays) 0-5ml (fixed cup on single tray)
Packing Speed	40-60 (bag/min)	40-60 (bag/min)	20-40 (bag/min) 30-50 (bag/min) 40-60 (bag/min)
Bag Size	(W) : 30-100mm (L) : 30-120mm	(W) : 30-120mm (L) : 30-155mm	(W) : 30-150mm (L) : 30-155mm
	Bag size can be lengthened according to customer requirement		
Total Power	720W	1400W	1600W
Voltage	380V or 220V 50Hz	380V or 220V or made accordingly	
Machine Weight	190kg	200kg	250kg
Machine Size	625x751x1558mm	625x751x1558mm	930x730x1700mm
Item Number	48400200	48400240	48400300

STEP DCF-200 Automatic Three-Side Sealing Powder Packaging Machine**POWDER**

Model	STEP DCF 200 Three-side/Four-side Sealing	STEP DCF-240 Three-side/Four-side Sealing	STEP DCF-300 Three-side/Four-side Sealing
Method of Measurement	Screw Type		
Range of Measurement	0-100ml (0-5ml, 5-20ml, 20-50ml, 30-100ml) Each machine with one screw	0-100ml (0-5ml, 5-20ml, 20-50ml, 30-100ml)	0-350ml (0-5ml, 5-20ml, 20-50ml, 30-100ml, 80-350ml)
	Each machine with one screw		
Packing Speed	40-60 (bag/min)	40-60 (bag/min)	20-40 (bag/min) 30-50 (bag/min) 40-60 (bag/min)
Bag Size	(W) : 30-100mm (L) : 30-120mm	(W) : 30-120mm (L) : 30-155mm	(W) : 30-150mm (L) : 30-155mm
	Bag size can be lengthened according to customer requirement		
Total Power	1100W	1400W	1600W
Voltage	380V or 220V or made accordingly		
Machine Weight	200kg	200kg	250kg
Machine Size	625x751x1558mm	625x751x1558mm	1010x730x1780mm
Item Number	48401200	48401240	48401300

STEP DCJ-200-240- 300 Liquid Packing Machine**LIQUID**

Model	STEP DCJ-200 Three-side/Four-side Sealing	STEP DCJ-240 Three-side/Four-side Sealing	STEP DCJ-300 Three-side/Four-side Sealing
Method of Measurement	Piston Type		
Range of Measurement	0-100ml	0-100ml	0-100ml, 50-150ml 50-200ml (made accordingly)
Packing Speed	40-60 (bag/min)	40-60 (bag/min)	20-40 (bag/min) 30-50 (bag/min) 40-60 (bag/min)
Bag Size	(W) : 30-100mm (L) : 30-120mm	(W) : 30-120mm (L) : 30-155mm	(W) : 30-150mm (L) : 30-155mm
	Bag size can be lengthened according to customer requirement		
Total Power	1100W	1400W	1600W
Voltage	380V or 220V or made accordingly		
Machine Weight	190kg	200kg	250kg
Machine Size	625x751x1558mm	625x751x1558mm	1010x730x1700mm
Item Number	48402200	48402240	48402300

STEP DCJ-200 Automatic Three-side Sealing Piece/Counting Type Packing Machine**PEICES**

Model	STEP DCP-200 Three-side Sealing	STEP DCP-240 Three-side/Four-side Sealing	STEP DCP-300 Three-side/Four-side/Back Sealing
Method of Measurement	Piece-counting type		
Range of Measurement	According to the size of the actual piece		
Packing Speed	40-60 (bag/min)	40-60 (bag/min)	20-60 (bag/min)
Bag Size	(W) : 30-100mm (L) : 30-120mm	(W) : 30-120mm (L) : 30-150mm	(W) : 30-150mm (L) : 30-155mm
Total Power	875W	1400W	1600W
Voltage	380V or 220V or made accordingly		
Machine Weight	180kg	190kg	220kg
Machine Size	625x751x1558mm	625x751x1558mm	1010x730x1780mm
Item Number	48403200	48403240	48403300

STEP DCFD-300 Tip-bucket Automatic Packing Machine

Specifications	
Bag Shape	Three-side , Four-side、 Back, Triangle Sealing
Method of Measurement	Bucket Volume
Range of Measurement	0-350ml
Packing Speed	20-40 (bag/min) 30-50 (bag/min) 40-60 (bag/min)
Bag Size	(W) : 30-150mm (L) : 30-155mm Bag size can be lengthened according to customer requirement
Total Power	1600W
Voltage	380V or 220V or made accordingly
Machine Weight	250kg
Machine Size	930x1300x1700mm
Item Number	48403310

STEP DCKK-300 Automatic Double Dispenser Granule Packing Machine

Specifications	
Bag Shape	Three-side , Four-side、 Back Sealing
Method of Measurement	Cup type
Range of Measurement	0-100ml for each
Packing Speed	40-80 (bag/min)
Bag Size	(W) : 30-150mm (L) : 30-170mm
Total Power	1600W
Voltage	380V or 220V or made accordingly
Machine Weight	260kg
Machine Size	Cup type
Item Number	48404160

STEP GF-50/1000 Semiautomatic Filling Machine

Model	GF-50	GF-1000
Method of Measurement	Screw Type	
Range of Measurement	0-50ml(0-5ml,5-20ml,20-50ml)	0-1000ml (0-5ml,5-20ml,20-50ml,5-100ml,100-1000ml)
	Each machine with one screw	
Feeding System	Manual feeding	Feeding by shaking filler machine
Power	220V 410W	220V 450W
Machine Size	720x580x1700mm	720x580x1750mm
Item Number	48404100	48404110

**STEP DCFDS-300 Tip-Bucket Packaging Machine, Triangle Bag Shape**

Specifications	
Method of Measurement	Bucket volume
Range of Measurement	0-350ml
Packing Speed	20-40 bag/min 30-50 bag/min 40-60 bag/min
Bag Size	W: 30-120mm L: 30-170mm
Total Power	1600W
Voltage	380V or 220V or made accordingly
Machine Weight	250kg
Machine Size	1010x730x1780mm
Item Number	48404150

**STEP DCJS-300 Liquid/Paste Packing Machine, Triangle Bag Shape**

Specifications	
Method of Measurement	Piston type
Range of Measurement	0-100ml
Packing Speed	20-40 bag/min 30-50 bag/min 40-60 bag/min
Bag Size	W: 30-120mm L: 30-170mm
Total Power	1600W
Voltage	
Machine Weight	250kg
Machine Size	1010x730x1780mm
Item Number	48404140

STEP DCKK-400 Granular Packaging Machine

Specifications	
Method of Measurement	Cup type; two hoppers
Range of Measurement	0-100ml (single plant)
Packing Speed	20-40 bag/min 30-50 bag/min 40-60 bag/min
Bag Size	W: 30-180mm L: 30-170mm
Total Power	2400W
Voltage	
Machine Weight	300kg
Machine Size	950x740x1800mm
Item Number	48404170

**STEP DCKS-300 Granular Packaging Machine**

Specifications	
Method of Measurement	Cup type
Range of Measurement	0-100ml
Packing Speed	20-40 bag/min
Bag Size	W: 30-180mm L: 30-170mm
Total Power	1600W
Voltage	
Machine Weight	250kg
Machine Size	1010x730x1780mm
Item Number	48404130

STEP SLJ-100 Shaking Auger Filler Machine

Specifications	
Method of Measurement	Auger type
Volume	100L
Feeding Speed	1M3/H
Total Power	618W
Voltage	
Machine Weight	80kg
Item no.	48404120

