

Operation & Maintenance Manual

IMPULSE AUTOSEALER OPERATION GUIDE

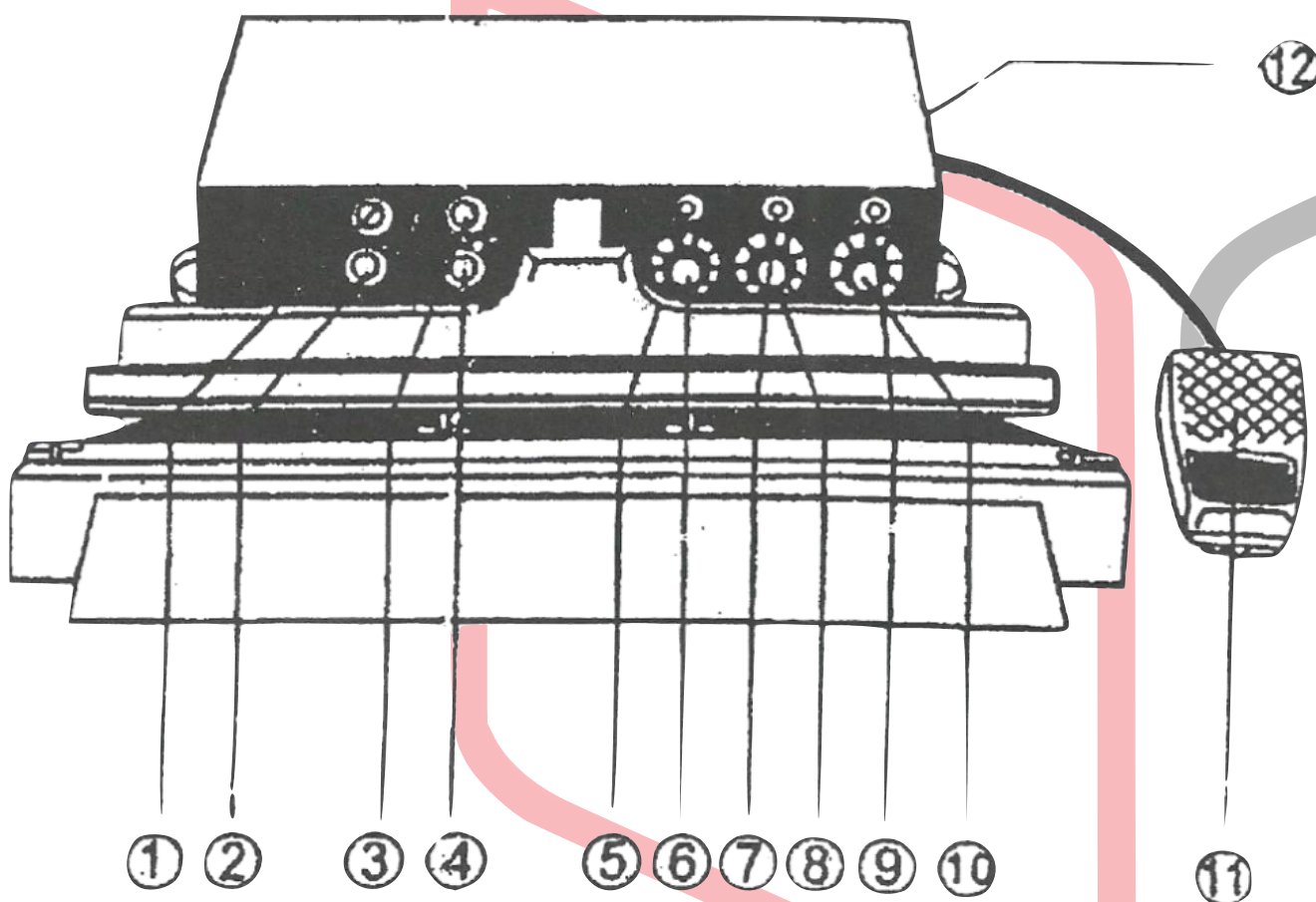

- Read this manual carefully prior to use.
- Technology is subject to change without further notice.

I. INSTRUCTION BOOKLET

1. Power Indicating Lamp (YELLOW)
2. Power Main Switch
3. AUTO-Action Lamp (WHITE)
4. AUTO-MAN Action Selector
5. Re-Cycle Indicating Lamp (YELLOW)
6. Re-Cycle Timer Control Knob
7. Congealing Indicating Lamp (RED)
8. Congealing Timer Control Knob
9. Sealing Indicating Lamp (RED)
10. Sealing Timer Control Knob
11. Foot Pedal Switch
12. Fuse

II. OPERATING INSTRUCTION

1. Set power main switch to ON position.
2. Set selector to MAN position for manual operation by pressing the foot pedal switch, or set selector to AUTO position for automatic operation.
3. Adjust the re-cycle time knob, appropriate to the frequency of continuous work.
4. Adjust the sealing time (heating time) knob, appropriate to the ness of the plastic bag.
5. Adjust the congealing time (pressing time) knob, appropriate to the thichbeauty of seal (to be cooled).

*Sealing and Congealing time are according to the material and thickness of the plastic bags. Re-cycle time is according to the working speed of the operator.

III. CONSTRUCTION DIAGRAM

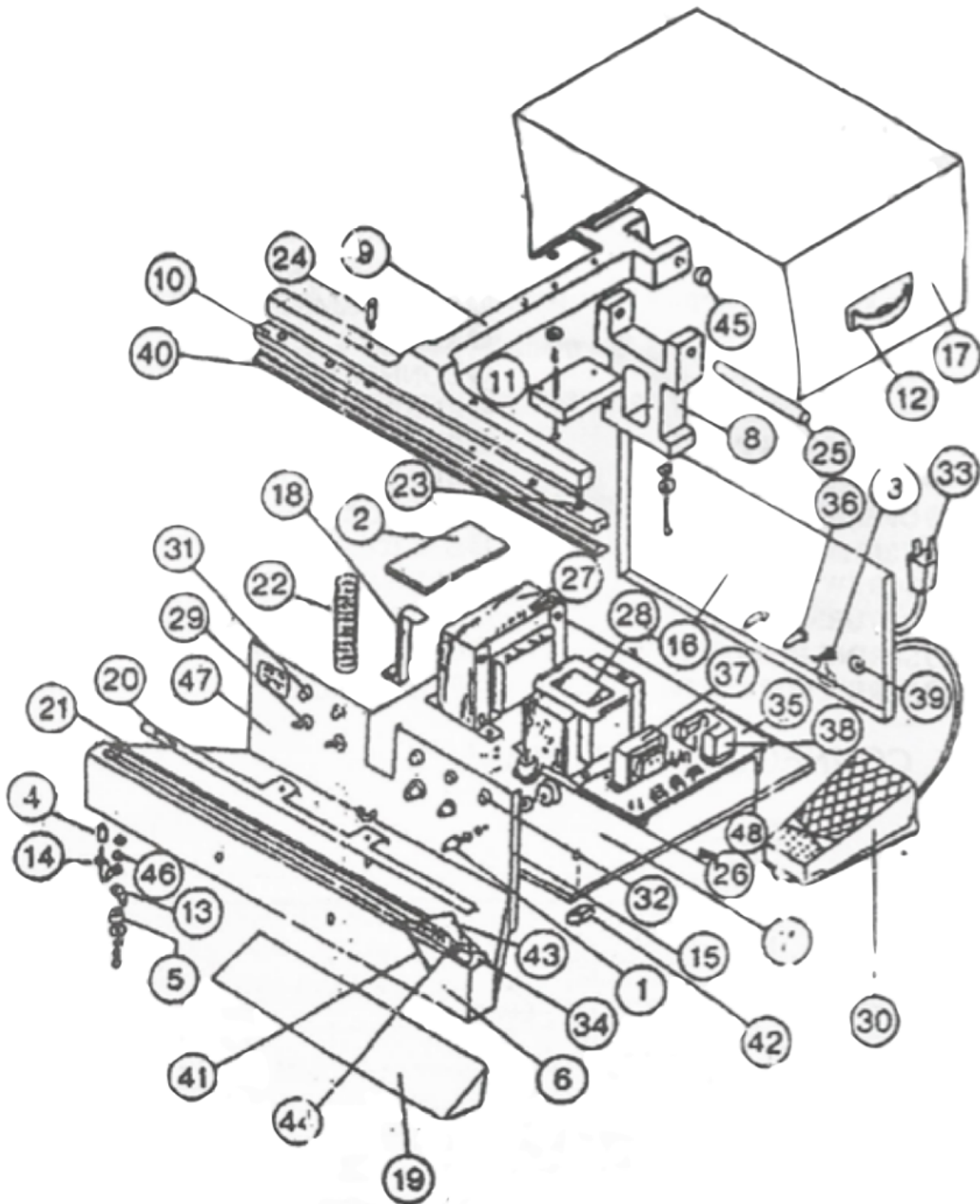

IV. PARTS LIST

- | | |
|--------------------------|--------------------------|
| 1. TIMER KNOB | 25. HINGE PIN |
| 2. PLASTIC PLATE | 26. SPRING BRACKET |
| 3. BUSHING | 27. TRANSFORMER |
| 4. BAKELITE PIPE | 28. SOLENOID |
| 5. CONVEX BAKELITE | 29. TOGGLE SWITCH |
| 6. LOWER JAW | 30. FOOT SWITCH |
| 7. BASE PLATE | 31. SIGNAL LIGHT |
| 8. HINGE BRACKET | 32. LED LIGHT |
| 9. UPPER JAW | 33. POWER SUPPLY CORD |
| 10. UPPER JAW SUPPORT | 34. HEATING ELEMENT |
| 11. FLAT PLATE | 35. CONTROL-PCB |
| 12. HANDLE STRAP | 36. FUSE BRACKET |
| 13. BRASS CONTACT | 37. PCB-TRANSFORMER |
| 14. TENSION SPRING | 38. RELAY |
| 15. FRONT PLATE | 39. CONNECTOR FOOT PEDAL |
| 16. BACK PLATE | 40. RUBBER PRESSURE PAD |
| 17. TOP COVER PLATE | 41. RUBBER STRING |
| 18. SPRING LEVER | 42. RUBBER FOOT |
| 19. OPERATING BOARD | 43. UPPER BARRIER TAPE |
| 20. CLIP FOR CLOTH | 44. BOTTOM BARRIER TAPE |
| 21. SCREW FOR CLOTH | 45. BOTTOM BARRIER TAPE |
| 22. RETURN SPRING | 46. PIN WASHER |
| 23. SPRING FOR UPPER JAW | 47. INSULATION WASHER |
| 24. SCREW FOR UPPER JAW | 48. CONTROL PANEL |
| | 49. PCB SUPPORT |

V. CONNECTION DIAGRAM

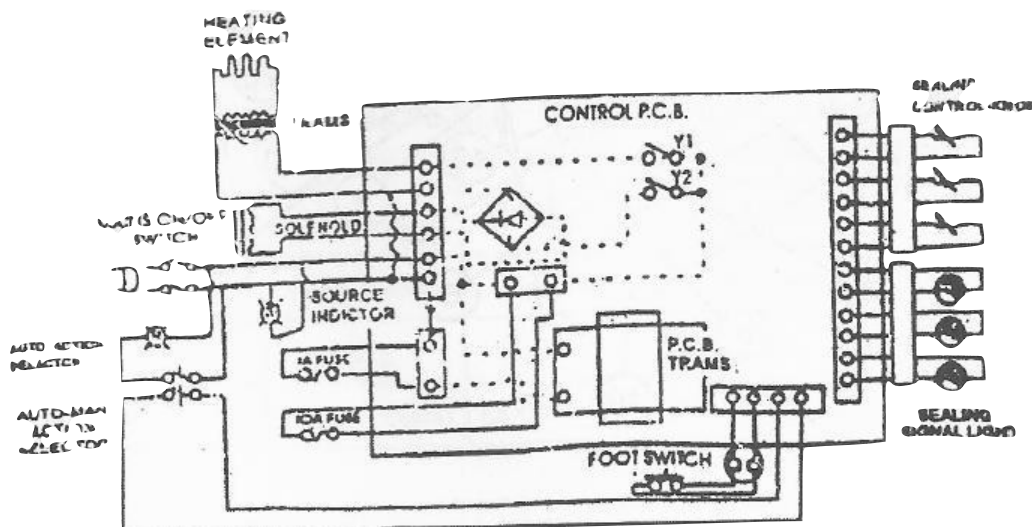

VI. ADDITIONAL INFORMATION

- Always Keep the sealing platform clean Particular care should be taken to remove any residue from over heated plastic from the barrier tape.
- Do not clean the sealing platform with anything wet.
- If the bottom barrier tape, (under the heating element) becomes worn, the heating element may short to earth, and this can damage the element.
- When replacing a heating element always check the condition of the bottom barrier tape it is also important that, when replacing a heating element, if genuine spares are not available, only thermo-electric wire of an identical specification (resistivity)
- After a long period of use the condition of the top pressure pad should be examined for wear. Obviously, any deformation will affect the quality of the weld and replacement may become necessary.

VII. SPARE PARTS

ASSESSORIES	Q'TY
HEATING ELEMENT	2
FUSE 10A	1
FUSE 1A	1

VIII. METHOD of EXCHANGING SUBSIDIARY PARTS

To replace the seal parts disused in case of heater consumed, please refer to followings;

1. Be sure to turn off the power before replacing.
 - Release fixed Teflon rubber, Teflon clip.
 - Pull out the Teflon tape, cut down the remainder, then, fix rubber and tape.
 - Fix Teflon screw, then it must to be rotated, pull tightly the Teflon tape and fix Teflon clip.
2. Method of replace heating element.
 - Release Teflon clip.
 - Heaters pole must be enclosed to inner side in order to release the heating element. (Heater's pole is tightened by at two end)
3. After replace the heater, please fix the teflon tape according to the previous method.

